

T90-8 HS

APT908HS

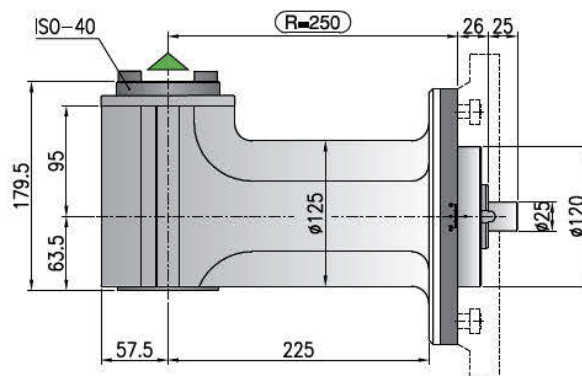

Minimum diameter without tool
Diametro minimo senza utensile

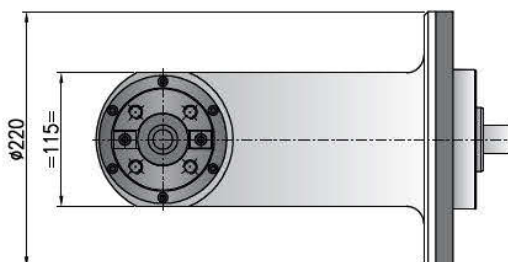
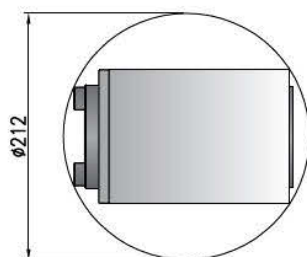

Direction of rotation same as machine spindle / senso di rotazione uguale al mandrino



Ratio
Rapporto
1:1



RPM
Velocità
5.000 min⁻¹



Max. axial load
Max. carico assiale
2.400 N



Torque
Momento torcente
100 Nm



Weight
Peso
33 kg



ISO/BT 40

*** STANDARD EQUIPMENT INCLUDES:**

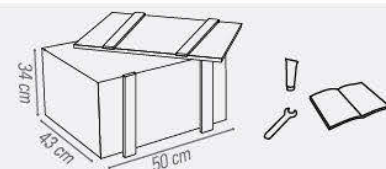

Shank/Cono	DIN-69871	CAT	MAS-BT	HSK	CAPTO	KM

Option / Opzione



bar max
12

Coolant through spindle
Adduzione refrigerante interna



HSK-63 CAPTO C4 C5

Quick Change
Attacco rapido



AIR/OIL

Air / oil lubrication
Lubrificazione aria / olio

T90-8 HP

APT908HP



Ratio
Rapporto
1:1



RPM
Velocità
3.000 min⁻¹



Max. axial load
Max. carico assiale
2.400 N



Torque
Momento torcente
200 Nm



Weight
Peso
33 kg



ISO/BT 40



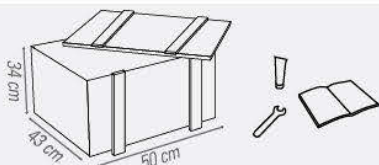

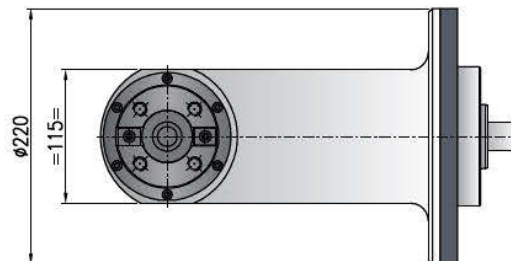
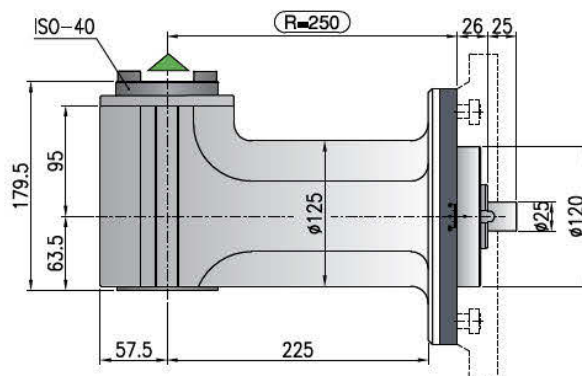
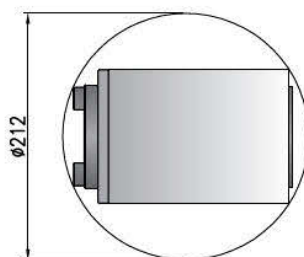

* STANDARD EQUIPMENT INCLUDES:



Minimum diameter without tool
Diametro minimo senza utensile



Direction of rotation same as machine spindle / senso di rotazione uguale al mandrino

Shank/Cono	DIN-69871	CAT	MAS-BT	HSK	CAPTO	KM
						

Option / Opzione



bar max
12

Coolant through spindle
Adduzione refrigerante interna



HSK-63A CAPTO C4 C5

Quick Change
Attacco rapido



AIR/OIL

Air / oil lubrication
Lubrificazione aria / olio

TDU-8

APTDU80C

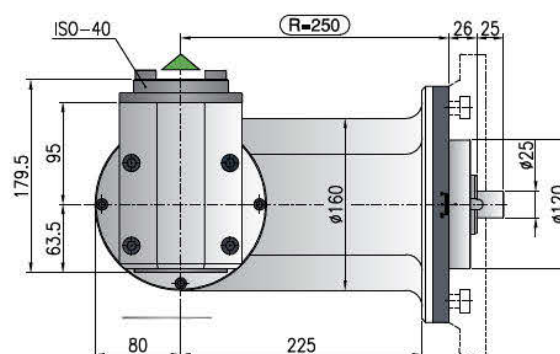

Minimum diameter without tool
Diametro minimo senza utensile

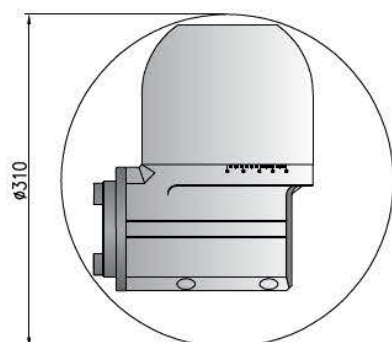

Ratio
Rapporto
1:1



RPM
Velocità
3.000 min⁻¹



Max. axial load
Max. carico assiale
2.400 N



Torque
Momento torcente
100 Nm



Weight
Peso
50 kg



Collet
Pinza

*** STANDARD EQUIPMENT INCLUDES:**

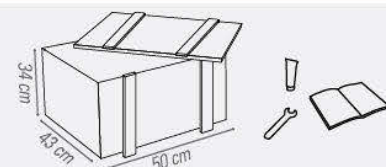

Direction of rotation same as machine spindle / senso di rotazione uguale al mandrino

Shank/Cono	DIN-69871	CAT	MAS-BT	HSK	CAPTO	KM

Option / Opzione



bar max
12

Coolant through spindle
Adduzione refrigerante interna



HSK-63A CAPTO C4 C5

Quick Change
Attacco rapido



AIR/OIL

Air / oil lubrication
Lubrificazione aria / olio

T90-8 XL - R=450 / 650 / 850



Ratio
Rapporto
1:1



RPM
Velocità
3.000 min⁻¹



Max. axial load
Max. carico assiale
2.400 N



Torque
Momento torcente
100 Nm



Collet
Pinza
ISO/BT 40

*** STANDARD EQUIPMENT INCLUDES:**

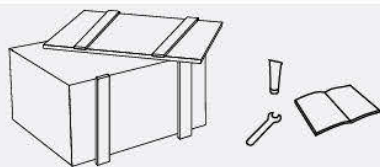

Minimum diameter without tool
Diametro minimo senza utensile

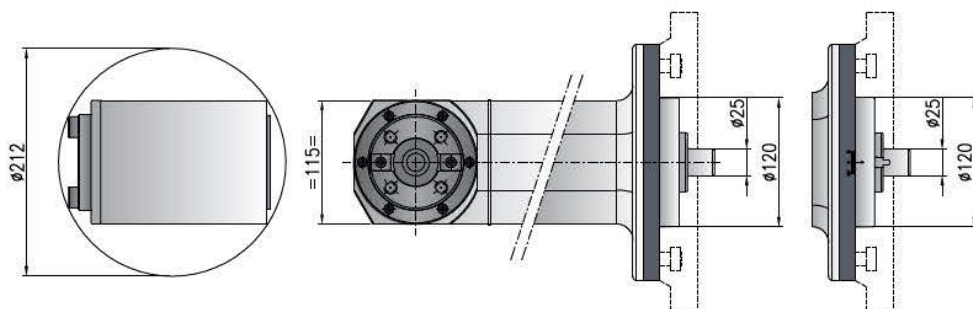





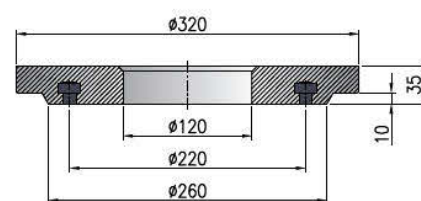
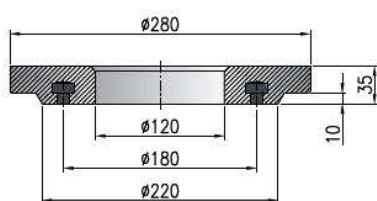

R= 450 / 650

R= 850



 Direction of rotation same as machine spindle / senso di rotazione uguale al mandrino

Shank/Cono	DIN-69871	CAT	MAS-BT	HSK	CAPTO	KM
						

Option / Opzione



bar max
12

Coolant through spindle
Adduzione refrigerante interna



HSK-63A CAPTO C4 C5

Quick Change
Attacco rapido



AIR/OIL

Air / oil lubrication
Lubrificazione aria / olio

APT9080P.450 / APT9080S.650 / APT9080S.850



Weight
Peso
105 kg

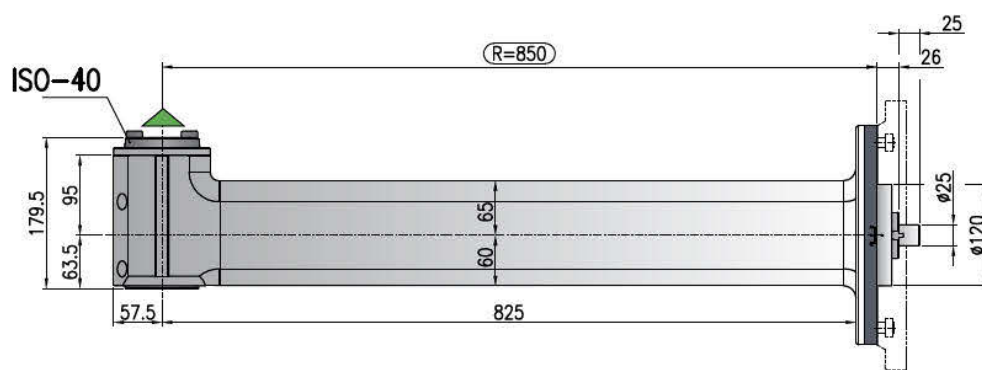

Weight
Peso
75 kg

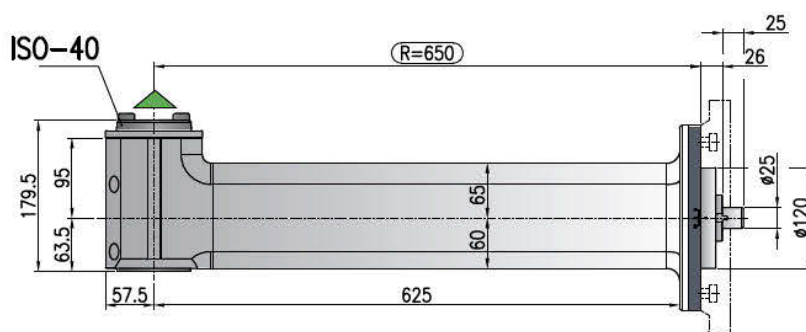

Weight
Peso
62 kg

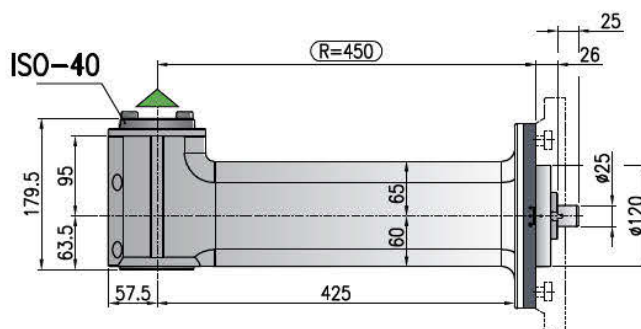

TCU-8 R.I. 15 BAR

APTCU80C



Ratio
Rapporto
1:1



RPM
Velocità
3.000 min⁻¹



Max. axial load
Max. carico assiale
2.400 N



Torque
Momento torcente
100 Nm



Weight
Peso
72 kg



ISO/BT 40

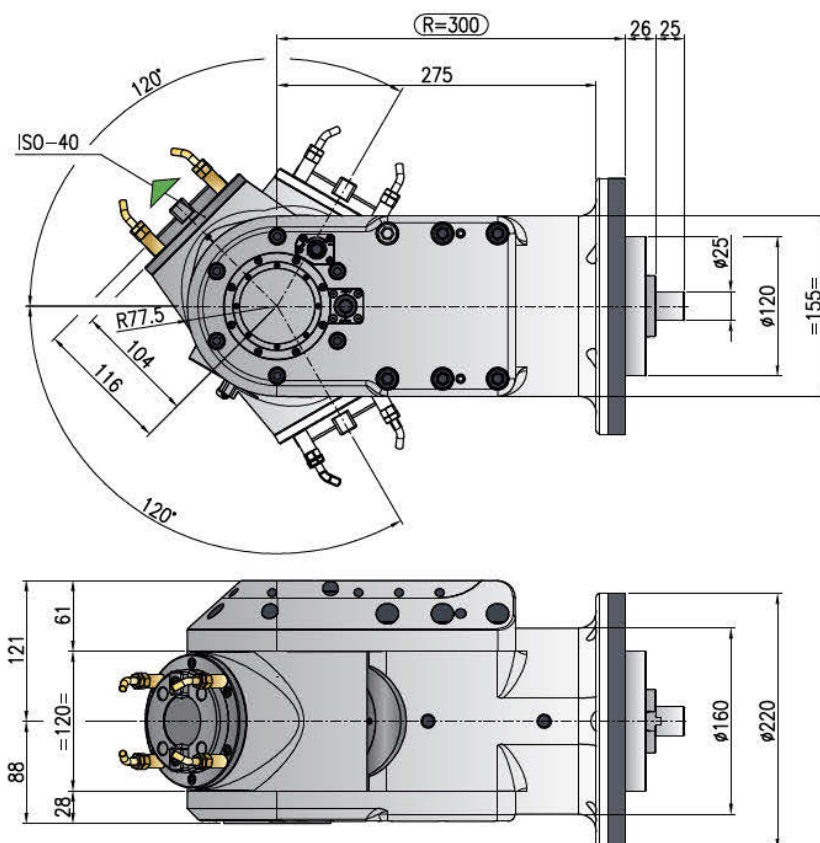

*** STANDARD EQUIPMENT INCLUDES:**



Direction of rotation same as machine spindle / senso di rotazione uguale al mandrino

						
Shank/Cono	DIN-69871	CAT	MAS-BT	HSK	CAPTO	KM

Option / Opzione



bar max
12

Coolant through spindle
Adduzione refrigerante interna



HSK-63

Quick Change
Attacco rapido



OIL

Oil lubrication
Lubrificazione

T90-10

APT9010C

Minimum diameter without tool
Diametro minimo senza utensile

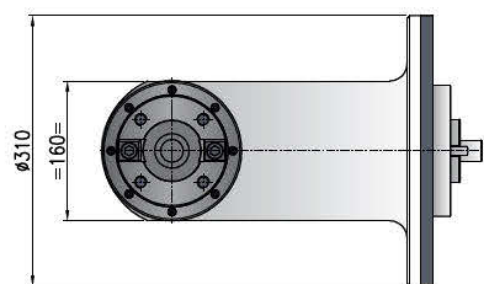
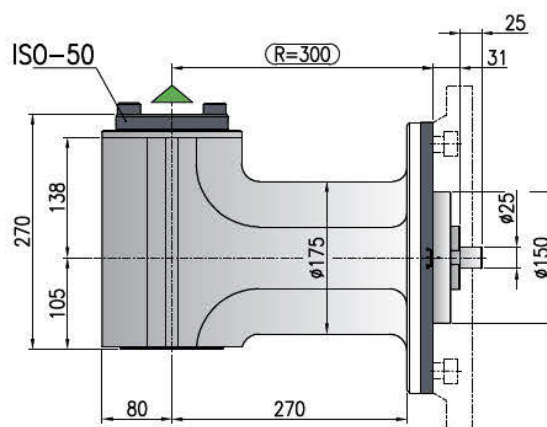
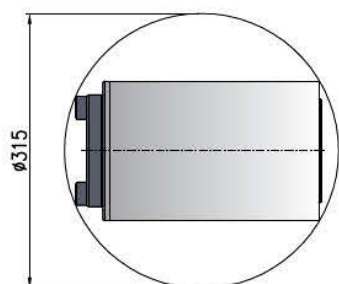

Ratio
Rapporto
1:1



RPM
Velocità
3.000 min⁻¹



Max. axial load
Max. carico assiale
3.300 N



Torque
Momento torcente
250 Nm



Weight
Peso
77 kg



Collet
Pinza
ISO/BT 50

*** STANDARD EQUIPMENT INCLUDES:**

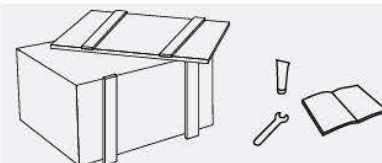

Direction of rotation same as machine spindle / senso di rotazione uguale al mandrino

Shank/Cono	DIN-69871	CAT	MAS-BT	HSK	CAPTO	KM

Option / Opzione



bar max
12

Coolant through spindle
Adduzione refrigerante interna



HSK-100

Quick Change
Attacco rapido



AIR/OIL

Air / oil lubrication
Lubrificazione aria / olio

TDU-10

APTDU10C



Ratio
Rapporto
1:1



RPM
Velocità
3.000 min⁻¹



Max. axial load
Max. carico assiale
3.300 N



Torque
Momento torcente
250 Nm



Weight
Peso
121 kg





Collet
Pinza
ISO/BT 50

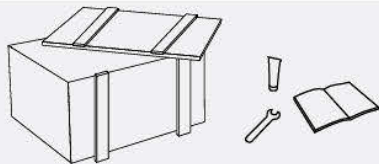



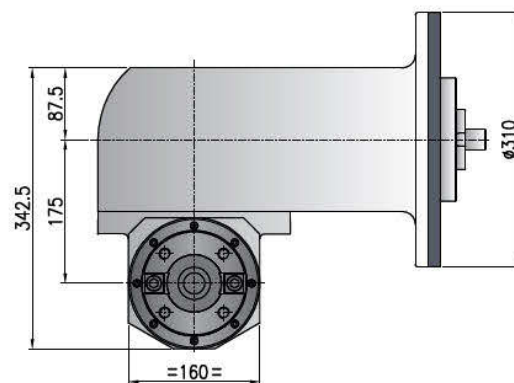
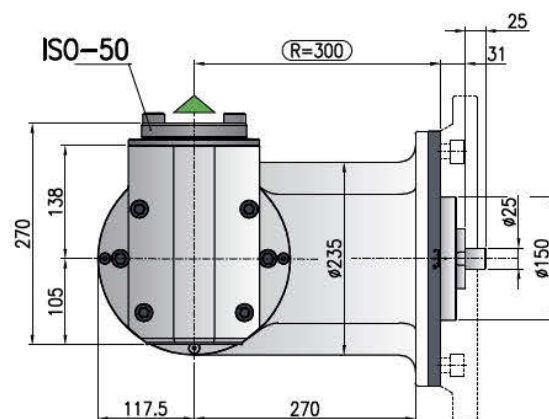
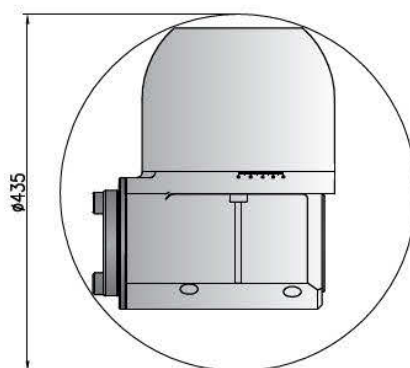

*** STANDARD EQUIPMENT INCLUDES:**



Minimum diameter without tool
Diametro minimo senza utensile



 Direction of rotation same as to machine spindle / senso di rotazione uguale al mandrino

Shank/Cono	DIN-69871	CAT	MAS-BT	HSK	CAPTO	KM
						

Option / Opzione



bar max
12

Coolant through spindle
Adduzione refrigerante interna



HSK-100

Quick Change
Attacco rapido



AIR/OIL

Air / oil lubrication
Lubrificazione aria / olio

TCU-10 R.I. 15 BAR

APTCU10C

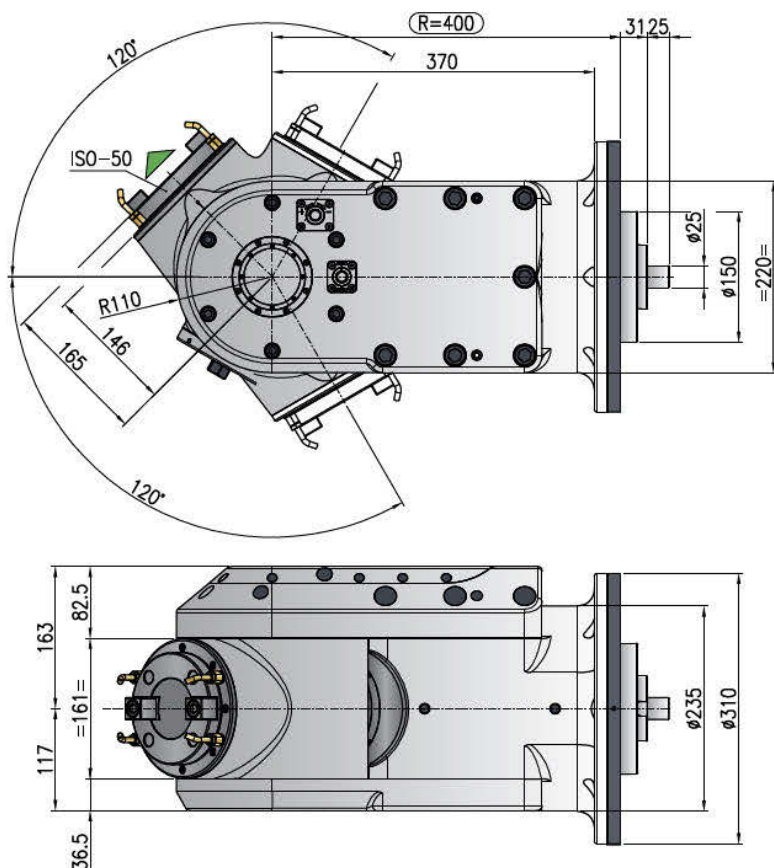

Direction of rotation same as machine spindle / *senso di rotazione uguale al mandrino*



Ratio
Rapporto
1:1



RPM
Velocità
3.000 min⁻¹



Max. axial load
Max. carico assiale
3.300 N



Torque
Momento torcente
250 Nm



Weight
Peso
194 kg



Collet
Pinza
ISO/BT 50

*** STANDARD EQUIPMENT INCLUDES:**



Shank/Cono	DIN-69871	CAT	MAS-BT	HSK	CAPTO	KM

Option / Opzione



bar max
12

Coolant through spindle
Adduzione refrigerante interna



HSK-100

Quick Change
Attacco rapido



OIL

Oil lubrication
Lubrificazione

TR90-15



Ratio (riduzione)
Rapporto (reduction)
1.875:1



RPM
Velocità
2.500 min⁻¹



Max. axial load
Max. carico assiale
3.900 N



Torque
Momento torcente
600 Nm





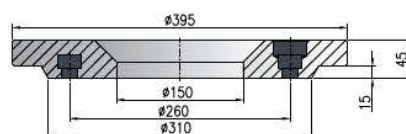
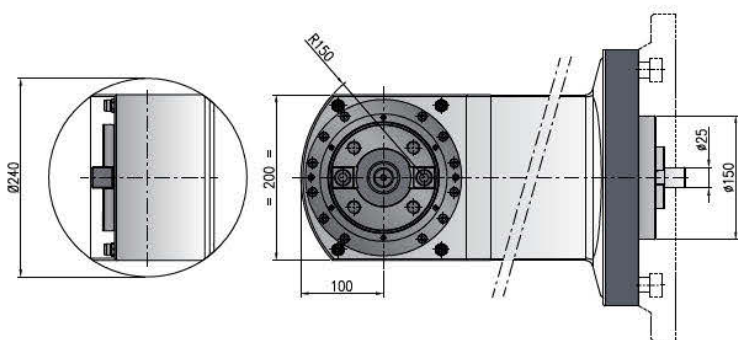

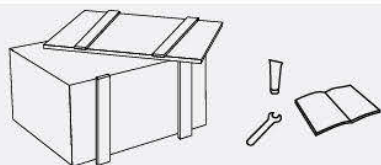

Collet
Pinza
ISO/BT 50



*** STANDARD EQUIPMENT INCLUDES:**



Direction of rotation same as machine spindle / *sensò di rotazione uguale al mandrino*

Shank/Cono	DIN-69871	CAT	MAS-BT	HSK	CAPTO	KM
						

Option / Opzione



bar max
12

Coolant through spindle
Adduzione refrigerante interna



HSK-63

Quick Change
Attacco rapido



AIR/OIL

Air / oil lubrication
Lubrificazione aria / olio

APTTR9015C

